

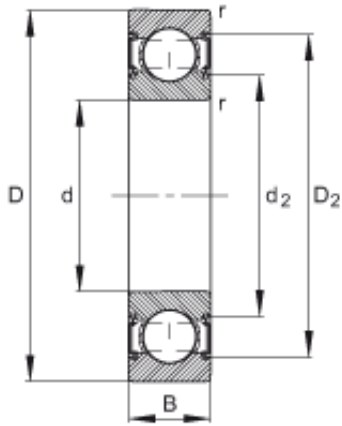

Timken BEARINGS ITALIA S.P.A.



12 mm x 28 mm x 8 mm FAG 6001-C-2HRS Single Row Ball Bearings

Bearing No. 6001-C-2HRS

6001-C-2HRS Bearing 2D drawings and 3D CAD models

Size	12x28x8 mm
Bore Diameter	12 mm
Outer Diameter	28 mm
Width	8 mm
d	12 mm
D	28 mm
B	8 mm
D_2	25,4 mm
$D_{a \max}$	26 mm
d_2	15,4 mm
$d_{a \min}$	14 mm
$r_{a \max}$	0,3 mm
r_{\min}	0,3 mm
m	0,022 kg / Weight
C_r	5500 N / Dynamic load rating (radial)
C_{0r}	2370 N / Static load rating (radial)
n_G	24500 1/min / Limiting speed